



- UCH/ENTERPRISE
- UCMC
- WCH
- DRAKE - LTCH
- DRAKE - BWP
- DRAKE - SNF
- DRAKE - OUTPATIENT
- AMBULATORY/UCPC
- LEGAL/COMPLIANCE
- MEDICAL STAFF
- MEDICATION MGMT
- OTHER

STANDARD OPERATING PROCEDURE

SOP # UCMC-LVAD-SOP-011-01

SOP NAME VAD Dressing Change

ORIGINATION DATE 12/3/2011

SPONSORED BY Signature on File DATE 11/20/2017
Tiffany Chastang, RN/BSN
LVAD Coordinator

ADMINISTRATIVE APPROVAL Signature on File DATE 11/20/2017
Jenifer Harris, BSN, RN/BC/ CCPC
Interim Transplant Administrator and
Clinical Director of Solid Organ
Transplant

Signature on File DATE 11/20/2017
Juliane Vierecke, MD

LAST REVIEW / REVISION DATE 11/20/2017 NEXT REVIEW DATE 11/20/2018

I. STANDARD OPERATING PROCEDURE

Administrative Interdepartmental Departmental Unit Specific

This document details the process for VAD Dressing Change for LVAD at UCMC.

II. PURPOSE

Ventricular Assist Device (VAD) dressings changes will be done daily and as needed, always using sterile technique.

If patient has two different ventricular assist devices, the dressing changes will be performed one at a time to minimize chance of cross-contamination.

This procedural guideline is intended for use of all UCMC patients including initial implantation, postoperative VAD, and re-admissions to any inpatient hospital area.

Deviations from this procedure will be ordered via a nursing communication order.

III. DEFINITIONS

VAD-ventricular assist device

IV. PROCEDURE

A. Equipment and Materials List:

1. Door sign, to read "Sterile dressing change in progress. Please do not enter."
2. Using the current LVAD II dressing kit (includes: instructions, hand sanitizer, 2 mask, 2 hair bouffant, sterile gloves x2, chloraprep swab 3 pack, betadine swab 3 pack, skin barrier, two 4x4 drain sponges, sterile dressing). **In addition to the kit you will need:**
 - a. Biopatch (**for initial implantation only unless ordered upon readmission**)
 - b. Driveline stabilizer
 - c. Disinfectant or bleach wipes, bedside table, trash can placed closed to bedside.
 - d. 2x2 alcohol pads to assist with adhesive removal of dressing

B. Policy Start Here

1. Obtain dressing kit or gather the appropriate supplies
2. Explain the procedure to the patient.
3. Place sign on door, close door to patient's room.
4. Position bedside table to same side of bed as driveline site. Ensure presence of trash can nearby for disposal of used supplies and old dressing. Cleanse surface of bedside table with disinfectant wipes.
5. Perform hand hygiene.
6. Open kit.
7. 2 Don hair covers, 2 masks, and 1 pair of sterile gloves (for RN) will be present with the first "unfold" of kit. Place these items on both the RN and pt.
8. Remove patient's driveline from the anchor for the dressing change
9. Remove old dressing without disturbing integrity of exit site (use a 2x2 alcohol pad to the outside edges of the dressing to assist with removal of dressing and preventing skin irritability).

10. Observe and report signs of skin irritability/infection/tenderness/pain at site.
11. Remove gloves.
12. Perform hand hygiene.
13. Unfold the other 3 edges of the sterile dressing kit.
14. Don sterile gloves.
15. With the 1st swab (betadine or chloraprep depending on what patient uses) work in concentric circles starting at the DL exist site and working outward. Please ensure not to lift the betadine or chloraprep stick away from the skin. With the 2nd swab repeat. With the 3rd swab, take it over DL starting from the exit site and clean on down the DL. Then **LIFT** swab to the untouched side and do the same on bottom side of DL working from the exit site and down the DL. Please note (do no scrub back and forth, do not manipulate the DL while cleaning, do not lift the wipe while performing concentric circles, and ALWAYS work from the exit site and always from DL.
16. Allow site to air dry (2 minutes).
17. Inpatient initial implant only-apply biopatch
18. Place 4x4 gauze (folded in half) under drive line about ½ inch
19. Place second 4x4 gauze over drive line site.
20. Apply skin barrier protectant onto surrounding area where dressing will be in contact with the skin. Allow this to air dry.
21. Place sterile dressing over the driveline site.
22. Apply skin barrier protectant to the site where the patient stabilizer will be applied. Allow this to dry. (Note: this is changed PRN. If stabilizer is not completely adhering to the skin, it's time to change).
23. Apply stabilizer making sure there is enough slack between the DL exit site to the stabilizer (the driveline should appear to make a "U" between exit site and stabilizer. Not allowing slack can cause chronic tension at the exit site).
24. Dispose of supplies
25. Remove gloves and perform hand hygiene
26. Time/date/initial dressing and document the daily dressing change in Epic.

LVAD Home Dressing Instructions (page 1 of 2)

Please follow facility dressing policy in addition to the following instructions



1 Perform hand hygiene. Position table in front of or on the same side as driveline site.



2 Ensure the presence of an open trash can nearby for disposal of used supplies and old dressing.



3 Clean table top with germicidal wipe or rubbing alcohol and allow to dry. Position mirror where you will be able to see driveline site throughout dressing change without touching it (remember the mirror is not sterile, so you will not be able to adjust it without breaking the sterile field).



4 Put on hair cover and mask.



5 Instruct all persons in the room to put on hair covers and masks.



6 Apply non-sterile gloves. Ensure driveline area is fully exposed and free of cords, tubing, patient clothing, or any other items.

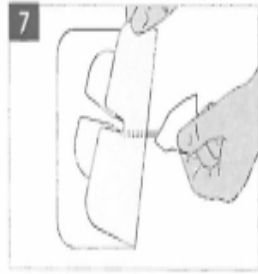

7 Remove the old dressing with detachal, being careful not to pull on the driveline (which could cause trauma to the entry site and expose you to infection). Use an alcohol swab under the dressing to release adhesive.



8 Discard old dressing and gloves in trash can. Observe area of insertion for any signs of infection (including redness, unpleasant odor, drainage, and pain).



9 Carefully open sterile LVAD dressing kit (touching only the outside edges) and place on clean, dry table.



10 Use sterile sari-wipe to clean hands again (especially around fingernails and between fingers).



11 Put on sterile gloves.

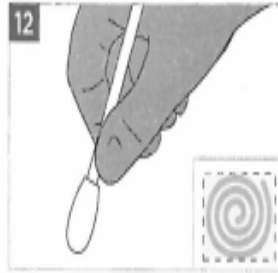

12 Use first Chloraprep® swab and clean UNDER the 4" x 4" driveline site covering. Gently wipe driveline exit site, wiping in concentric circles and working outward. DO NOT scrub back and forth - only clean away from driveline site.

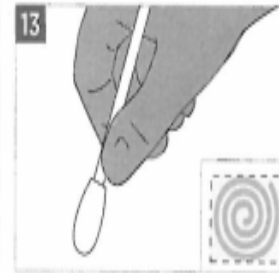

13 Use second Chloraprep swab and repeat previous

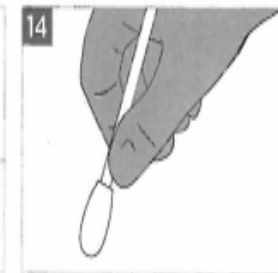

14 Use third Chloraprep swab to clean the actual driveline. Also remove circular motion square



15 Allow to air dry for a

Continued
on back side

Chloraprep® is a registered trademark of CareFusion Corporation or one of its affiliates. Contact manufacturer for complete instructions for use and product information. Use in accordance with the policies and procedures of your facility.

UCHealth LVAD Home Dressing Instructions-1 0327-17
911571

LVAD Home Dressing Instructions (page 2 of 2)

Please follow facility dressing policy in addition to the following instructions

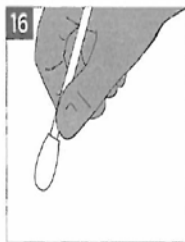

16 Open and apply skin protectant (no stinging barrier) to skin where dressing adhesive will contact skin. Allow to dry completely.

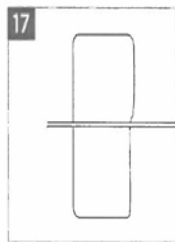

17 Fold 4"x4" split gauze in half and place under the driveline, allowing for a 1/2" gap between the gauze and the driveline exit site.

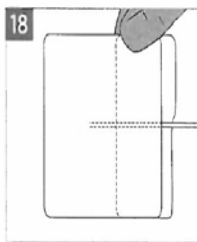

18 Place 4"x4" gauze over the driveline site.

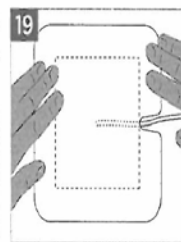

19 Apply dressing over exit site. Press gently from exit site out to edges to adhere dressing to skin.

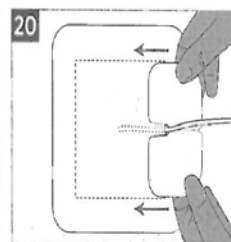

20 Apply closure piece. **Do not remove backing until in place.** Slide under driveline and over edge of dressing. When snug to drive line, remove backing one side at a time. Press gently out to edges to adhere.



21 Dispose of remaining supplies, then remove gloves and discard.



22 Perform hand hygiene. Notify VAD team if signs of infection are noted.

V. RESPONSIBILITY

Tasks	Responsible Staff

VI. KEY WORDS

LVAD Dressing change
Medipore
Chloraprep

VII. APPENDIX

None

VIII. RELATED FORMS

None

IX. REFERENCES / CITATIONS